

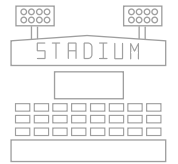

The Evac+Chair guide to
emergency evacuation plans during
UK Business Safety Week

EVAC+CHAIR[®]

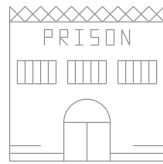
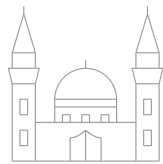
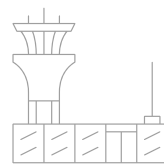
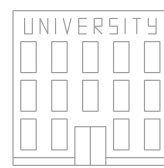
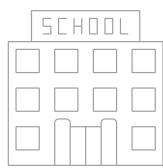
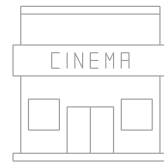
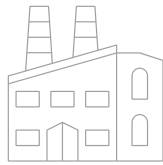
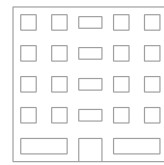
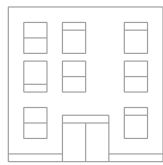

EVAC+CHAIR®

The Evac+Chair guide to
emergency evacuation plans during
UK Business Safety Week

Introduction

This guide to emergency evacuation plans has been produced in support of Business Safety Week to help businesses across the UK produce and monitor their **Fire Emergency Evacuation Plans (FEEP)**.

UK Business Safety Week, organised by the National Fire Chiefs Council, runs between 11 to 17 September 2017 with an aim of ensuring businesses and, employees have all the information they need to prevent, protect and respond to fire incidents in the workplace.

Evac+Chair International, manufacturers of the universal evacuation solution for smooth stairway descent during an emergency situation, understand the importance of training people on how best to deal with emergency situations and fire assessments.

During Business Safety Week, Evac+Chair is offering free evacuation advice from certified Evac+Chair trainers.

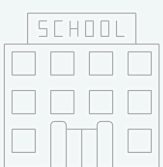
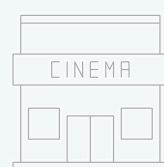
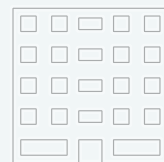

What are FEEPS?

A Fire Emergency Evacuation Plan (FEEP) is a document which includes all the actions to be taken by staff in the event of fire and the arrangements for calling the emergency services.

Your evacuation plan must show how you have:

- 1 A clear passageway to all escape routes
- 2 Clearly marked escape routes that are as short and direct as possible
- 3 Enough exits and routes for all people to escape
- 4 Emergency doors that open easily
- 5 A safe meeting point for staff.
- 6 A safe route for all including the mobility-impaired
- 7 Training for all employees to know and use the escape routes
- 8 Emergency lighting where needed

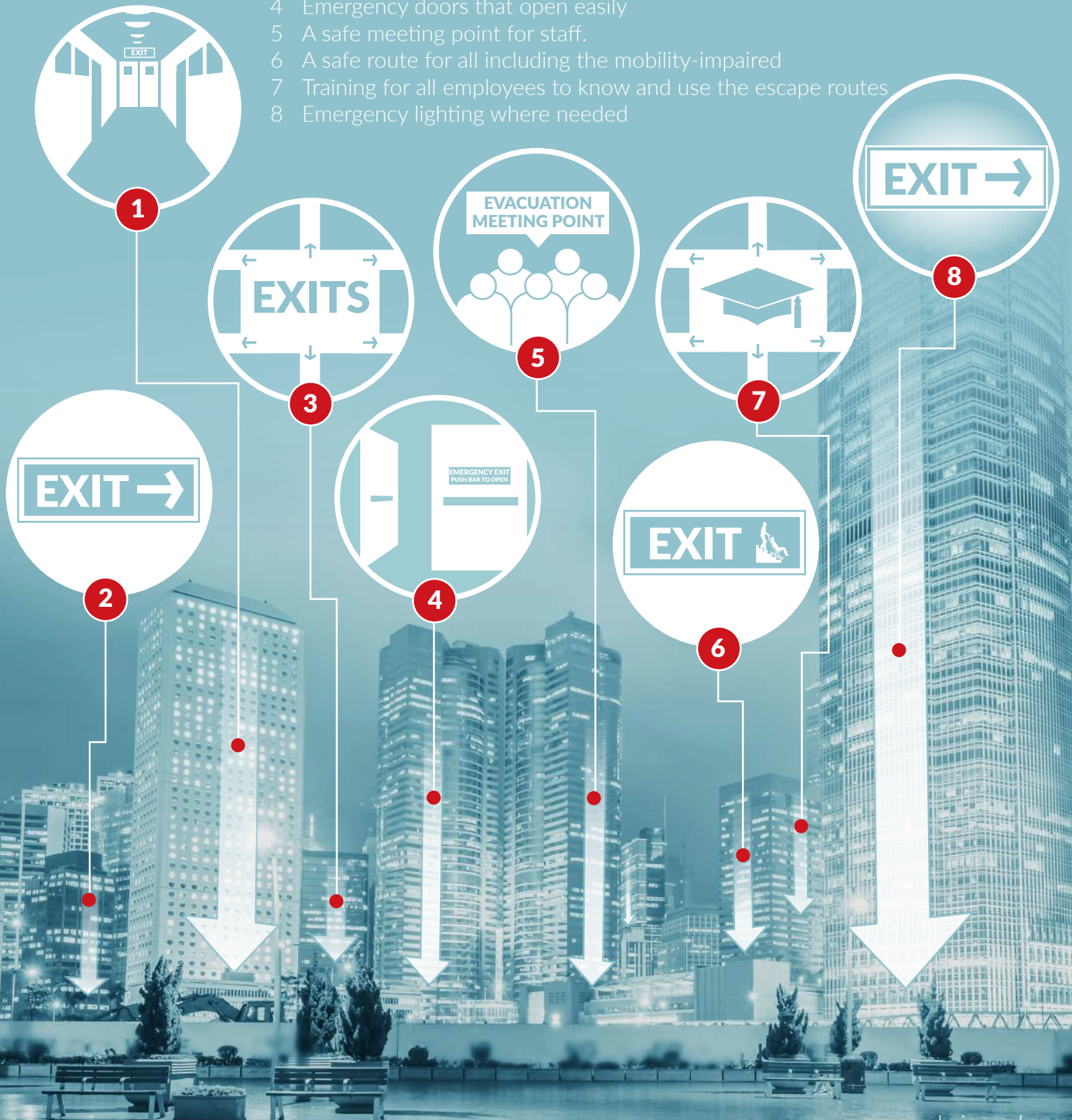

What should an evacuation plan look like?

The Fire Safety Order emphasises risk reduction and fire prevention. The main rules under the order are that workplaces must carry out a fire risk assessment, identify possible dangers and consider those who may be especially at risk.



Fire detection and warning system

You must have a suitable fire-detection and warning system ranging from a verbal warning to an electrically-operated detection and warning system.



Have a means of fighting a fire

You must have suitable extinguishers. Suited in both type and capacity as well as staff should be adequately trained in their use.



Escape routes

Everyone on your premises should be able to escape to a place of total safety needing neither a lift nor the help of fire and rescue professionals. Some people with disabilities may require assistance from colleagues and evacuation equipment to ensure they can exit a building, which is on fire, safely and efficiently.



Fire exit doors

Everyone – colleague, visitor and dedicated health and safety personnel - should be able to use a fire exit door and any other doors on an escape route without any specialist knowledge..



Record your findings

You should record the findings from steps 1 and 2: the hazards identified and the people who may be most at risk. Then record what you did as part of step 3 to reduce these risks.

If your business does not meet the Fire Safety Order, the fire authority will provide practical advice or, if the risk is serious, a formal notice may be issued.

What equipment do I need?

The Regulatory Reform (Fire Safety) Order 2005 states that it's the 'responsible persons', eg building owner or employer, who need to ensure everyone is evacuated safely during an emergency.

If you are the responsible person, you must ensure a fire risk assessment is carried out correctly. This person will be responsible, in law, for meeting the provisions of the Fire Safety Order, including all necessary safety equipment.

It is essential to identify people at risk. Workplaces must reduce the risk to these people – discussing their particular needs with them as part of the assessment. Specialist evacuation equipment - such as **Evac+Chairs** - would be needed to accompany anyone with mobility issues.



Conclusion

A fire emergency evacuation plan (FEPP) is a required emergency procedure for any business, as part of the Fire Safety Order. It's essential for all businesses to have a building evacuation plan and evaluate the level of risk present to be sure that, when an emergency does arise, everyone is as safeguarded as possible.

Evac+Chair International is supporting UK Business Safety Week to emphasise the importance of this and ensure that all workplaces have done the essential preparation and have the necessary equipment to reduce fire-associated risks.

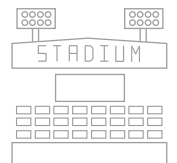

For your free evacuation training and advice, please contact Evac+Chair today.

T: +44 (0) 121 706 6744

E: enquiry@evacchair.co.uk

W: www.evacchair.co.uk

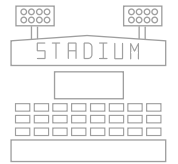
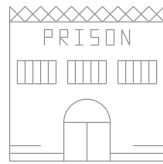
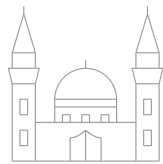
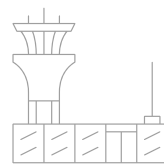
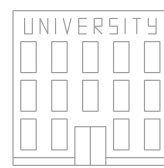
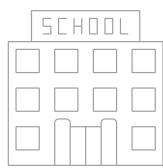
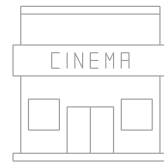
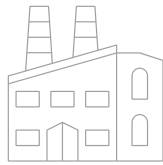
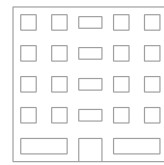
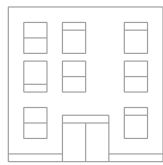

EVAC+CHAIR®

ParAid House,
Weston Lane,
Birmingham B11 3RS.
United Kingdom

T +44 (0)121 706 6744

W www.evacchair.co.uk

E enquiries@evacchair.co.uk